

**SECTION DD**

2no. 1400h x 780w Velux rooflights ref GGL 3000/M08

35°

900

2775

Living/Dining Room

wg19

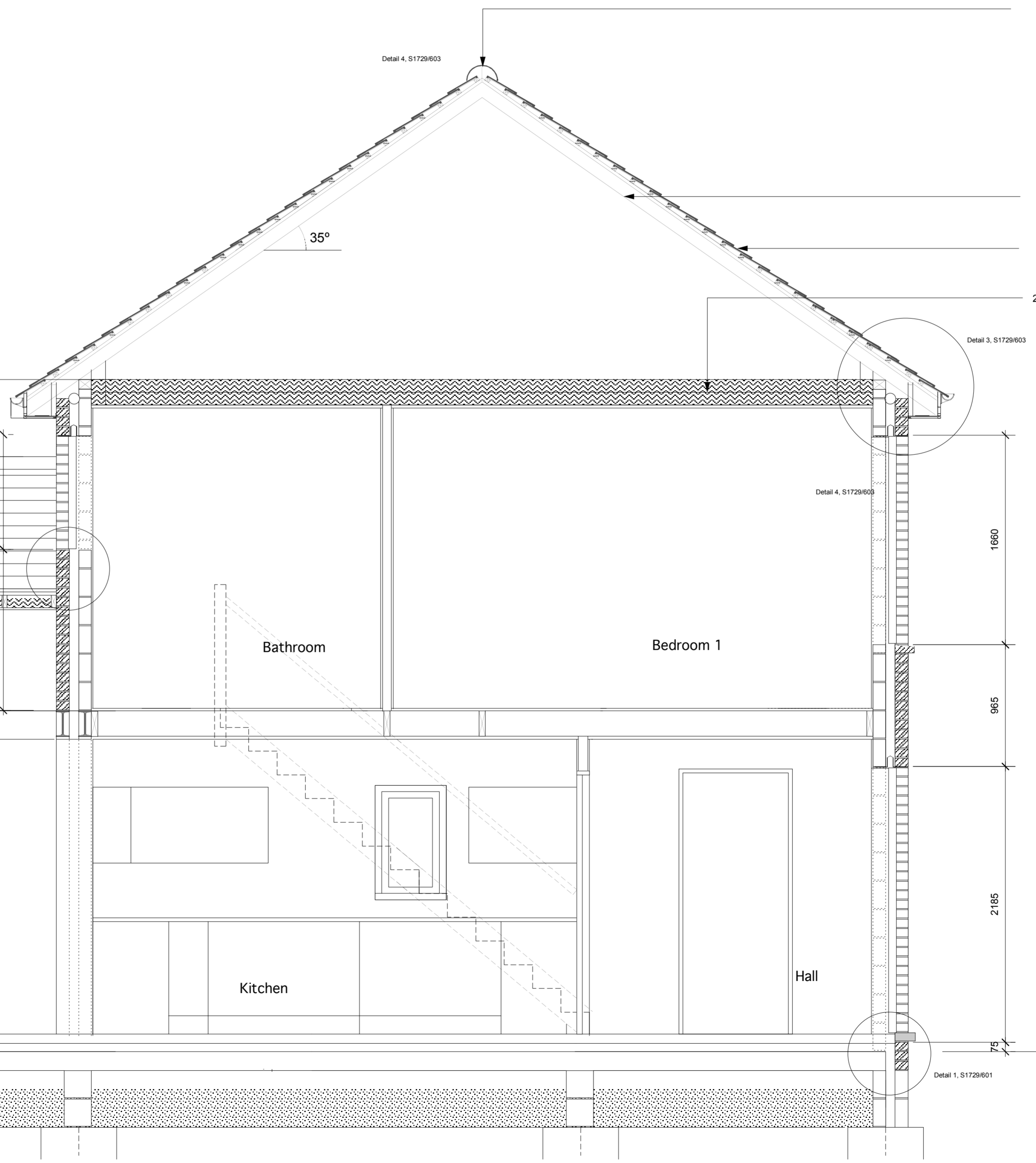

**SECTION AA**

half round ridge tiles on 15mm finished mortar bed

trussed rafter roof system with hips

Forticrete Gemini interlocking concrete tiles on pre-treated battens at 175mm centres on roofing felt

2no. layers of 100mm fibre thermal insulation (total 200mm) laid between and across trusses

35°

2no. 1400h x 780w Velux rooflights ref GGL 3000/M08

Forticrete Gemini interlocking concrete tiles

Milbank Roofs Unipur PB self-supporting roof panel system. Panels 820mm wide. Type ref PB150/170 183mm thick overall

transom & toplight

450

2110

150

Detail 5, S1729601

2625

810

1275

2700

Living/Dining Room

Bathroom

Bedroom 1

Kitchen

Hall

1680

985

2185

Detail 1, S1729601

Detail 4, S1729603

Detail 3, S1729603

Detail 4, S1729603

Rev E: Sept 04 - Section DD added  
 Rev D: Aug 04 - roof covering co-ordinated with details  
 Rev C: Aug 04 - co-ordinated Sections BB & CC  
 Rev B: July 04 - co-ordinated with struct. eng. drwgs  
 Rev A: July 04 - window dimensions amended

<p><b>SOUTH BANK ARCHITECTS</b></p> <p>28A LOWER MARSH LONDON SE1 7RG          tel: 020 7928 6144 fax: 020 7620 1966          email: sbarchitects@btconnect.com</p>	
<p>client</p> <p><b>DORIC SECURITIES LTD.</b>          "Riverside", Wandale Trading Estate, Mitcham, Surrey CR4 4HW</p>	
<p>project</p> <p><b>WOOD AVENUE, PURFLEET THURROCK, ESSEX</b></p>	
<p>title</p> <p><b>HOUSE 5: SECTION AA AND SECTION DD</b></p>	
<p>scale</p> <p><b>1:25</b></p>	<p>drawing no.</p> <p><b>S1729/511E</b></p>